

Lots to Love Framelits – Altered Box (downsized)

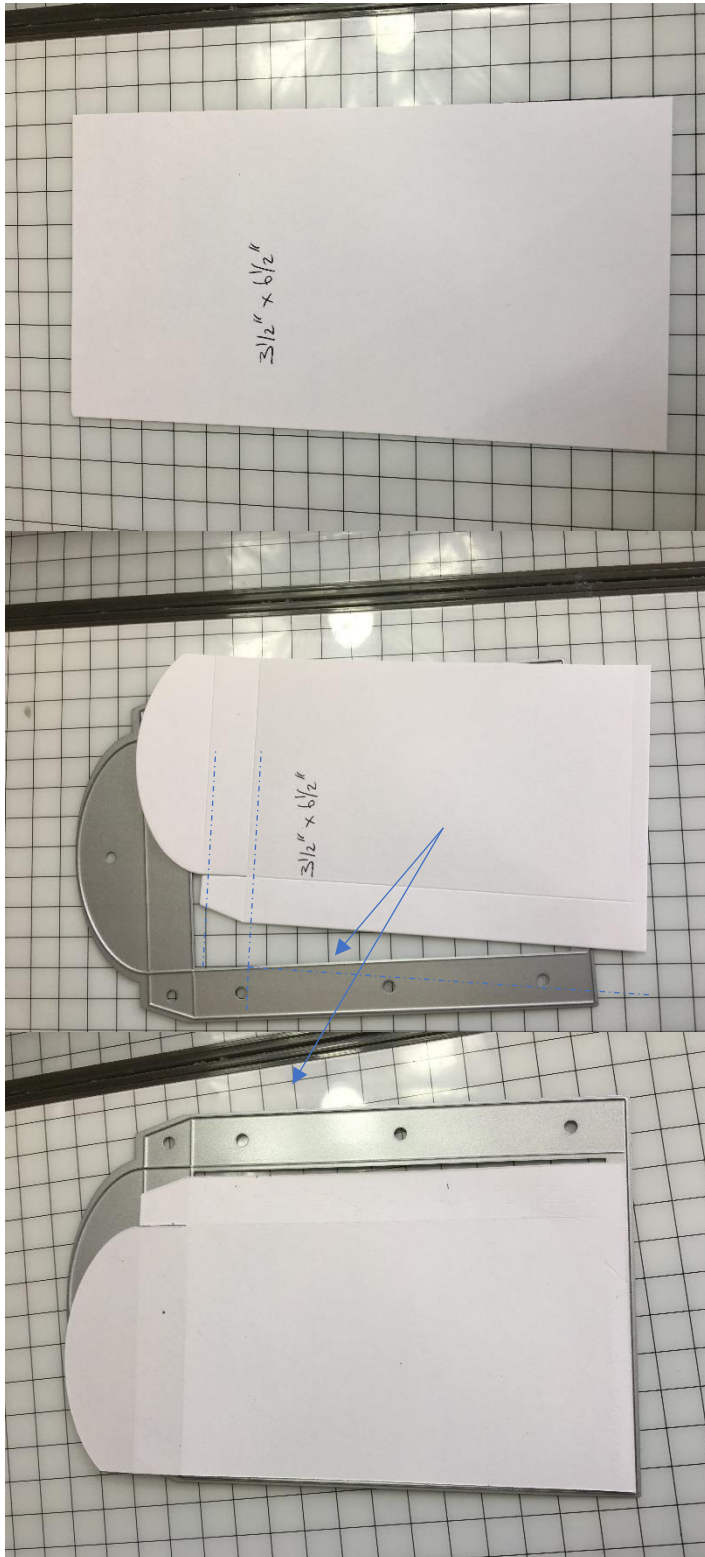

If content of box is going to be less than 4 1/4" x 3" then you can resize it down by this method.

To resize the box to fit 2 Fin Carre Chocolate Bars 2 1/8" by 4 1/2" I cut cardstock (this is scrap for illustration purposes only) to 3 1/2" x 6 1/2".

Position to die cut as normal but only to cut one side. I cut this on the Big Shot Machine.

Now turn position the uncut side to the die and cut the other side.

You could use a little masking tape or washi tape to hold this in place if you don't have the Magnetic Board although I simply placed the piece die then paper (rather than normal paper then die) to cut. That way I could see if it moved out of position.

It didn't. This is really easy to do.



Now your piece is cut to size.

You just need to round the top flap.

I did this using an appropriate sized circle die simply to draw around.

You could just as easily do it freehand.

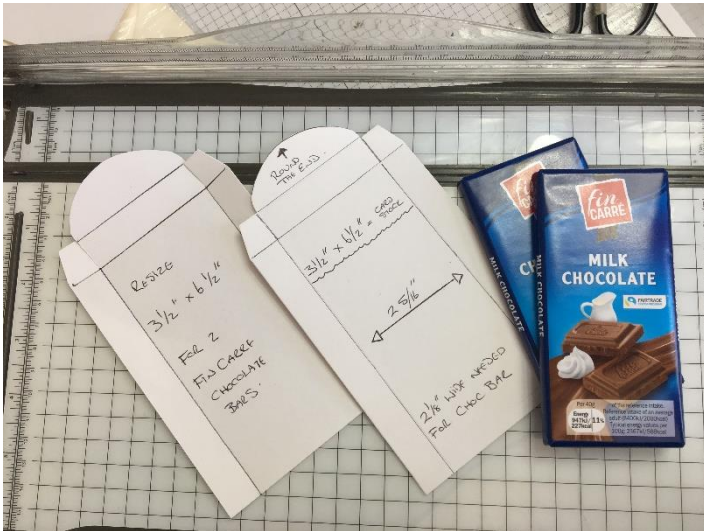

You will need to make 2 of these pieces and assemble by sticking together to create a flap at each end.

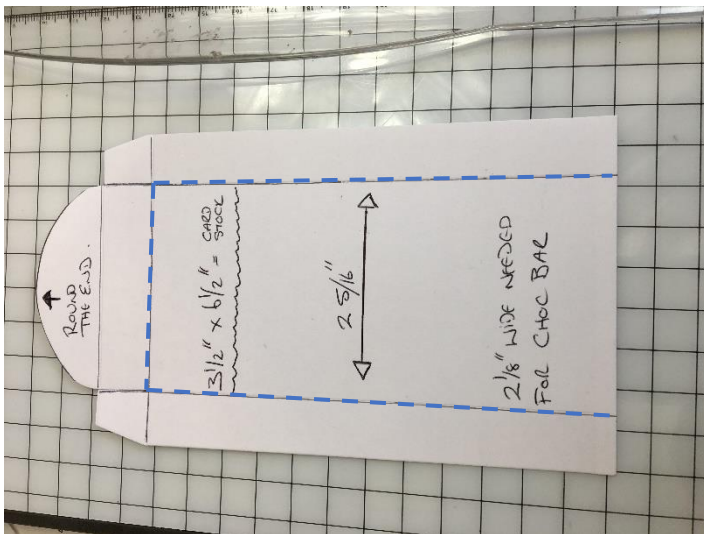

To recap:

You will need 2 of these.

Cardstock $3 \frac{1}{2}'' \times 6 \frac{1}{2}''$

To fit choc bar $2 \frac{1}{8}'' \times 4 \frac{1}{2}''$

To make your own bespoke measurement, measure width and depth required to fit within the scored area.

If necessary you could also make the box shorter as well as narrower.